

Ocean Knoll Elementary School Campus



Owner: Encinitas Union School District
Architect: Webb Cleff Architecture and Engineering

Owner: Encinitas Union School District
Architect: Webb Cleff Architecture and Engineering



Total Squ



Enviroplex delivers a unique building solution to accommodate growth at Ocean Knoll Elementary School.

When Encinitas Union School District saw a need to expand its Ocean Knoll Elementary School campus due to growth, the District contracted with Enviroplex to build and deliver 7,680 square feet of classroom space meeting a specified U-shaped footprint. The goal was to maximize the available campus space, maintain continuity within the existing structures and modernize the campus buildings. After reviewing a former project done by Enviroplex, Encinitas USD found that they would be able to meet all of the requirements needed to expand the campus. From start to finish, the project was a collaborative effort between the school district, Webb Cleff Architecture and Engineering, and Enviroplex.

Completed summer 2016, the classroom buildings' footprints are four 60x32 buildings housing two classrooms each and positioned to create a wonderful sense of class community. The custom window and door assemblies, a 3-coat stucco exterior, 1.5:12 integrated pitched roofs with finished soffits, and the custom colored two-tone paint scheme with contrasting door color complement the existing campus structures. The 5' front, 2'6" rear, and 18" side overhangs add a pleasing aesthetic to the buildings' strong horizontal lines, plus added protection from inclement weather.

The team at Enviroplex with the help of the Architect developed a building with a unique footprint which gave the appearance of a uniform building. The shape also created the central courtyard the District desired which resulted in a much more collaborative environment for the school's growing student population.



are Footage – 7,680 sq ft

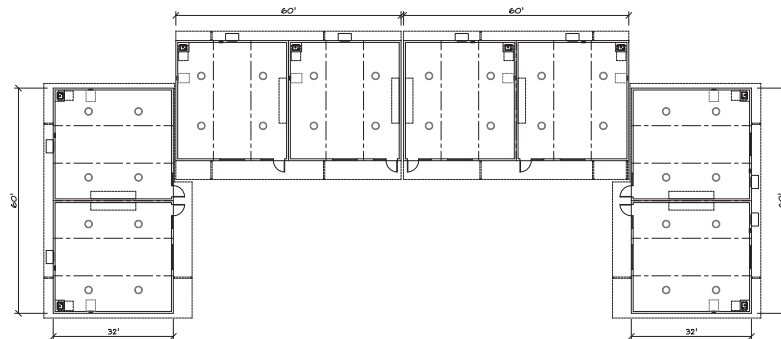

Ocean Knoll Elementary School campus

Key Building Features

- 1.5:12 pitched integrated roof with "Stone White" Kynar panels
- 3-Coat stucco exterior with control joints
- Acrylic finish coat with integral 2-tone color
- Stucco flange welded door frames with continuous hinges
- Custom store-front doors and windows
- 8x30 view lites
- Collins & Aikman "Infinity" carpet tiles
- Continuous gutters and Schedule 40 downspouts
- 16' Teaching wall with sliding marker boards and storage per classroom

Sustainable Building Features:

- Four Solatube tubular daylight devices per classroom
- LED lighting
- Low and no V.O.C. (Volatile Organic Compounds) paints and sealant materials
- "Comfort Cool" ducting system for increased air circulation and reduced decibels
- High efficiency 11 EER 2-stage compressors with MERV 11 filters
- Venstar thermostats
- R30 insulation in ceiling
- R19 insulation in walls



4777 E. Carpenter Road, Stockton, CA 95215

T. 209.466.8000 F. 209.461.6555 | www.enviroplex.com