

Franklin Child Care Center



Owner: Stockton Unified School District
Architect: Lionakis
Contractor: Turner Construction

ENVIROPLEX
High Performance Modular Buildings



Stockton Unified School District’s program for pregnant and parenting teens (School Age Family Education, or SAFE) needed a facility at its Franklin High School campus, and the district relied on Enviroplex to deliver a building that would allow teenagers with children to complete their education and gain the skills to become successful parents.

Completed in July 2010, the 1,920-square-foot facility was built with the use of six 10' x 32' modules. In partnership with district stakeholders and Lionakis architects, Enviroplex built a functional and aesthetically pleasing facility based on the program’s thoughtful intent. With the use of Eisenwall stucco siding and Kynar colored 2-foot standing seam metal panels on an integrated 2:12 pitched roof, the new building complements the existing campus structures and blends in with the adjacent learning environments and mature oak trees.



The child care center features restroom facilities, a kitchen and an administrative office with an interior window for viewing the main common space. Sustainable features include eight Solatubes, low-E dual-glazed windows and Marmoleum flooring.

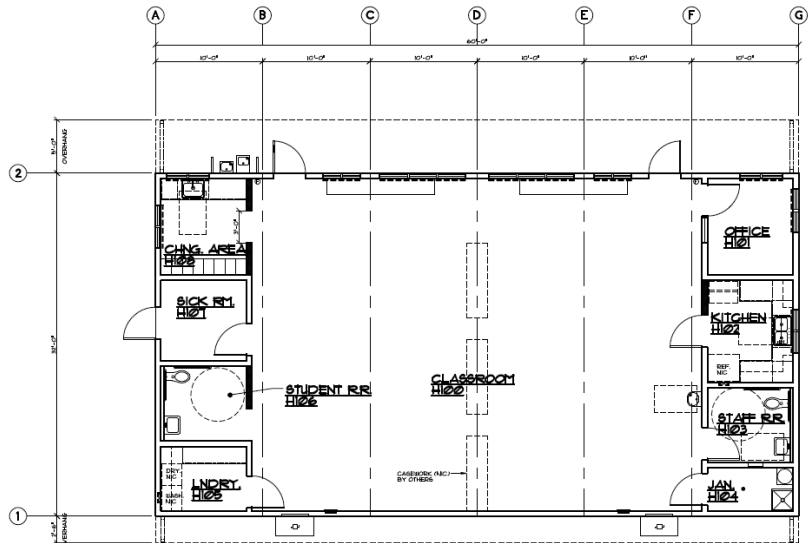

Total Square Footage – 1,920 sq ft

Franklin Child Care Center

Key Building Features

- Integrated 2:12 pitched roof design with Kynar colored standing seam metal panels
- Eisenwall stucco exterior
- Restrooms, custom office, kitchen, common area and special care spaces
- Exterior wall-mounted HVAC units
- 9-foot ceiling height
- Concrete stem-wall foundations
- Custom casework
- Custom Marmoleum flooring throughout; vinyl floors in restrooms and kitchen
- Low-E dual-glazed windows
- Solatubes